

Infotahvel rinnatise peal (S4)

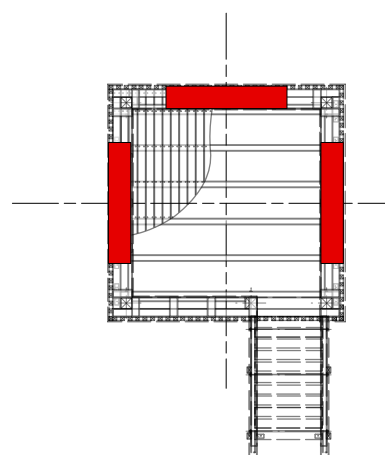

TAHVLI S4 ASEND PLATVORMIRINNATISEL

Platvormi nimepaneel (S3)

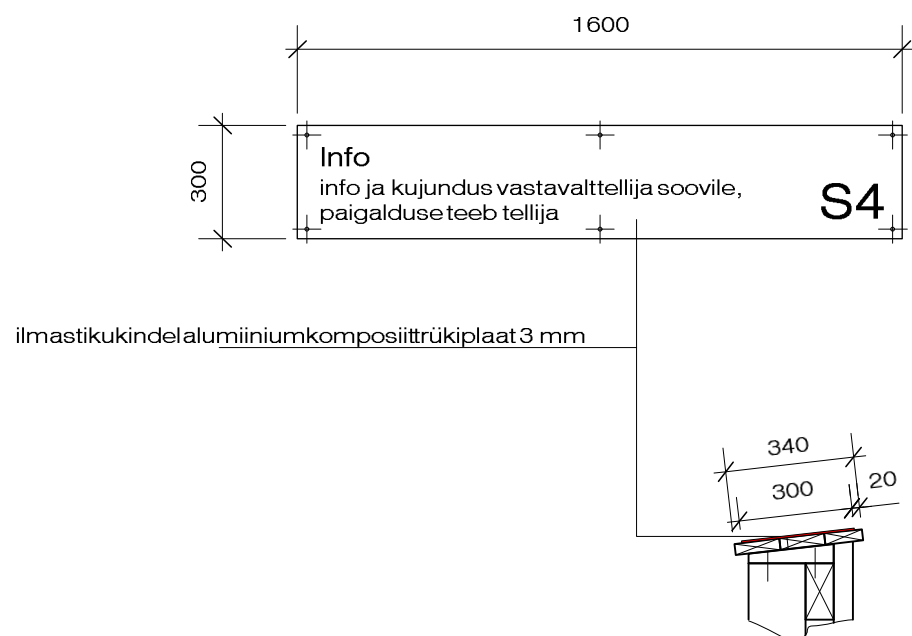
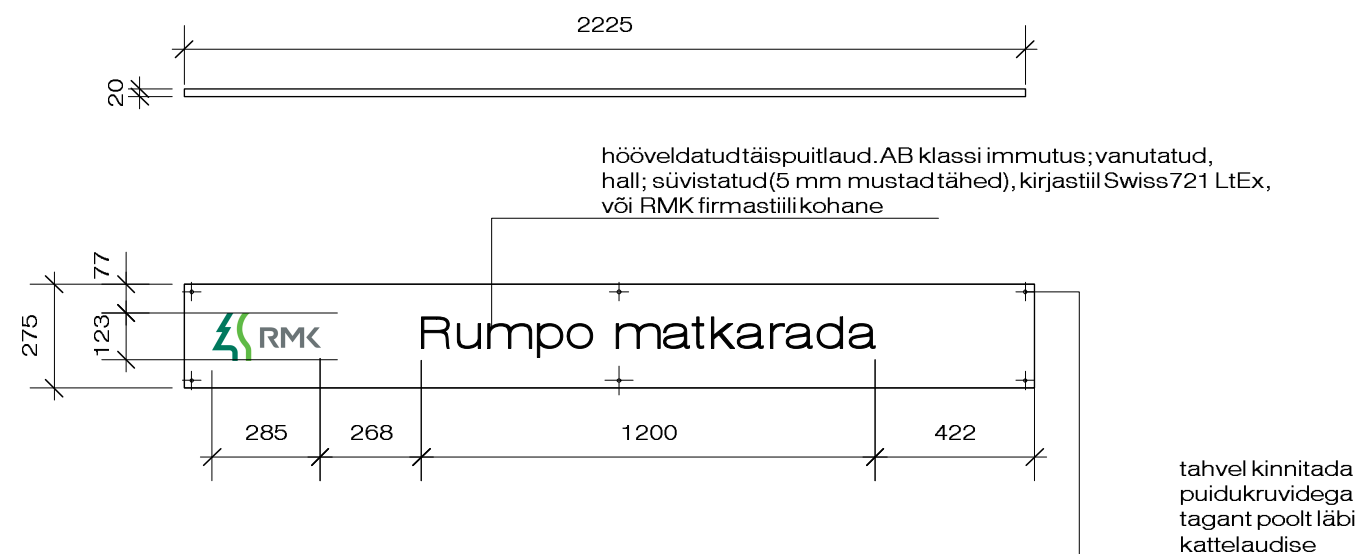

Infotahvlid (S1, S2)

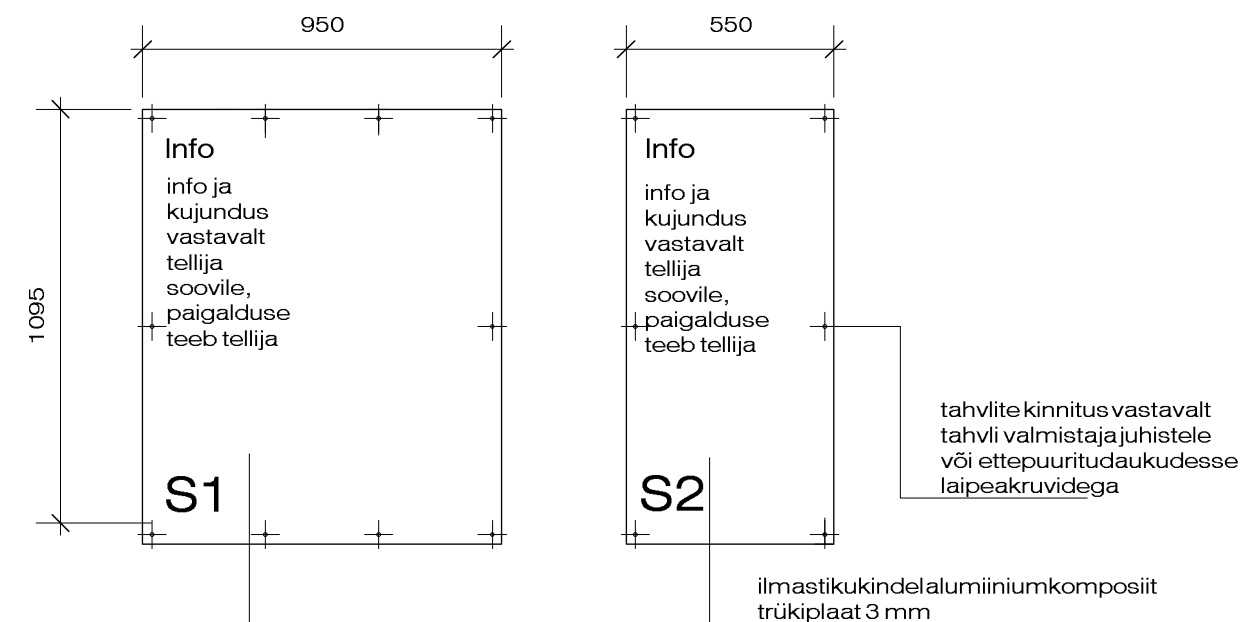

Märkused:

1. Infokandjate hulga, kujunduse jm, va S3, määrab RMK.
2. Infokandjad, va nimepaneel - S3, paigaldab RMK. Nimepaneel paigaldatakse platvormide ehitusel. Nimepaneeli paigaldamise otsustab RMK.